

WURTH WOOD GROUP

WURTH AND PRO LIGHTING

INVENTORY GUIDE



PRO TAPE 150

- Bright 150 Diodes w/3M peel and stick in a convenient 16.4' roll
- A break through in LED dimming. Can be dimmed off a wall dimmer by using the dimmable driver (must purchase an AMP adapter and an AMP Driver for use with a wall dimmer)
- CIC (Custom Interlink Connectors) enables the installation of the wiring to be precise
- Cut-to-Size every 4" and links back together by using CIC or Linkable Wires
- Available in Cool White & Warm White
- Size: .079"(2mm)H x .315"(8mm)W x 16.4'L
- 9 Watts, 12 Volts, Bulb Life: 50,000 hours



Individual Rolls

warm white	cool white	description
PROSA10350WW	PROSA10350WH	LED Tape, 9 Watts, 150 Diodes, 16.4' Roll

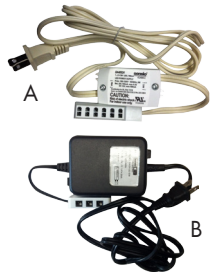

Compatible Drivers and Dimmable Drivers

item no.		description	Capacity
PROSA40638	A	10 Watts, 12V Driver w/3 MN Ports	18'
PROSA40592	B	15 Watts, 12V Dimmable Driver w/6 AMP Ports	27'

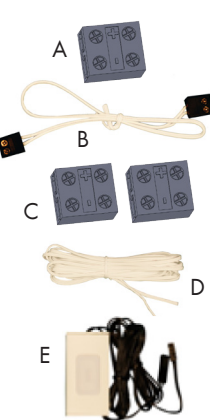

Accessories

item no.		description
PROSA10354		98" Power Cord w/ MN Connector
PROSA10352		98" Power Cord w/ AMP Adapter
PROSA10353	A	End to End Connector
PROSA10390	B	2" Linkable Wire, Connects (2) ProTape Strips Together
PROSA10392	B	12" Linkable Wire, Connects (2) ProTape Strips Together
PROSA10395	B	72" Linkable Wire, Connects (2) ProTape Strips Together
PROSA10396	C	Custom Interlink Connector, (2) Per Pack, connection of custom lengths of wire between strips
PROSA10397	D	25', 20 Gauge Stranded Copper Wire
PROSA40518	E	Touch Dimmer and ON/OFF Switch with 39" cable

12 DIODES LED FLEXIBLE STRIP LIGHTS

- A break through in LED dimming. Can be dimmed off a wall dimmer by using the dimmable driver
- 0.8 Watts, 12 Volts, Bulb Life: 50,000 hours
- Available in Warm White (3200K) or Cool White (5000K)
- Size: 0.31" (8mm) W X 0.1" (2.5mm) H X 11.81" (300mm) L

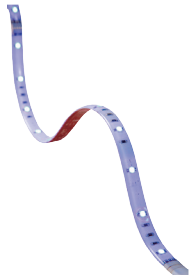

Individual Strips

warm white (3200K)	cool white (5000K)	description
09765637729611	09765637719611	Individual 11.81"L, 12 Diode LED Flexible Strip

LED Flexible Strip, 4 Strip Light Kits

warm white (3200K)	cool white (5000K)	description
09765637749611	09765637739611	4 Strip Kit: 98" cable, 6W Driver w/ 4 Port ML Block
09765637769611	09765637759611	4 Strip Kit: 98" cable, 15W Dim. Driver w/ 12 Port ML Block



Compatible Drivers and Dimmable Drivers

item no.	description	capacity
09765639599611	6 Watts, 12 V, LED Driver w/4 Port ML Block	7
09765639609611	30 Watts, 12 V, LED Driver w/12 Port ML Block	36
09765639759611	15 Watts, 12 V, LED Dimmable Driver w/12 Port ML Block	18

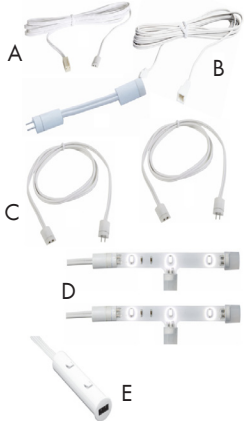

Accessories

item no.	description	application
09765639699611	A 98" Power Cable (Included in Kits)	Connects first LED Flexible Strip to ML Block
09765639539611	B 98" ML Power Extension Cable	Extends distance between ML Block to Light
09765639689611	C 1.97" Linkable Wire	Connects two LED Flexible Strips together
09765639679611	C 19.69" Linkable Wire	
09765639669611	C 59" Linkable Wire	
09765639929611	D 2.76" T-Shaped LED Flexible Strip, Cool White	Connects two LED Flexible Strips at a 90° angle
09765639659611	D 2.76" T-Shaped LED Flexible Strip, Warm White	
09765638169611	E Infrared On/Off Switch	Used to turn lights On/Off

Installation

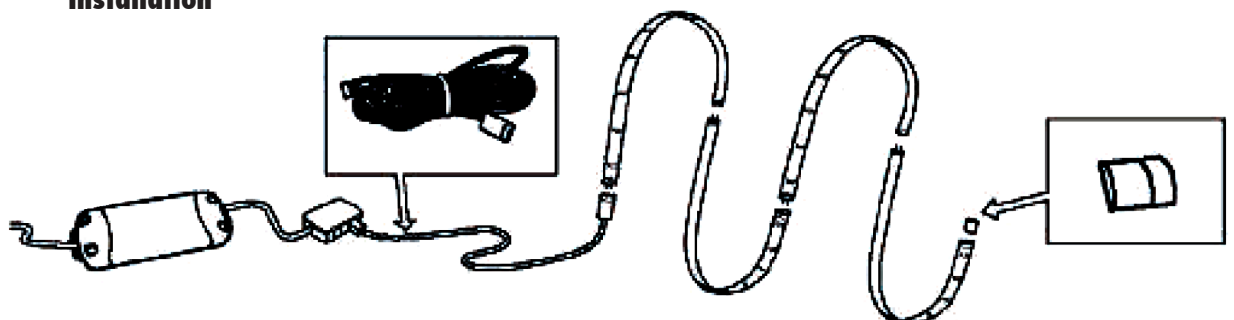

Note: Pricing subject to change without prior notice

72 DIODES LED FLEXIBLE STRIP LIGHTS

- A break through in LED dimming. Can be dimmed off a wall dimmer by using the dimmable driver
- 5 Watts, 12 Volts, Bulb Life: 50,000 hours
- Available in Warm White (3200K) or Cool White (5000K)
- Size: 0.31" (8mm) W X 0.1" (2.5mm) H X 78.74" (2,000mm) L

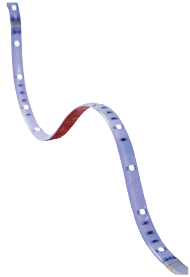

Individual Strips

warm white (3200K)	cool white (5000K)	description
09765637869611	09765637859611	Individual 78.74"L, 72 Diode LED Flexible Strip



Compatible Drivers and Dimmable Drivers

item no.	description	capacity
09765639599611	6 Watts, 12 V, LED Driver w/4 Port ML Block	7
09765639609611	30 Watts, 12 V, LED Driver w/12 Port ML Block	36
09765639759611	15 Watts, 12 V, LED Dimmable Driver w/12 Port ML Block	18

Accessories

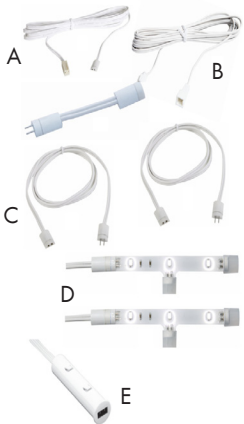

item no.		description	application
09765639699611	A	98" Power Cable (Included in Kits)	Connects first LED Flexible Strip to ML Block
09765639539611	B	98" ML Power Extension Cable	Extends distance between ML Block to Light
09765639689611	C	1.97" Linkable Wire	Connects two LED Flexible Strips together
09765639679611	C	19.69" Linkable Wire	
09765639669611	C	59" Linkable Wire	
09765639929611	D	2.76" T-Shaped LED Flexible Strip, Cool White	Connects two LED Flexible Strips at a 90° angle
09765639659611	D	2.76" T-Shaped LED Flexible Strip, Warm White	
09765638169611	E	Infrared On/Off Switch	Used to turn lights On/Off

Installation

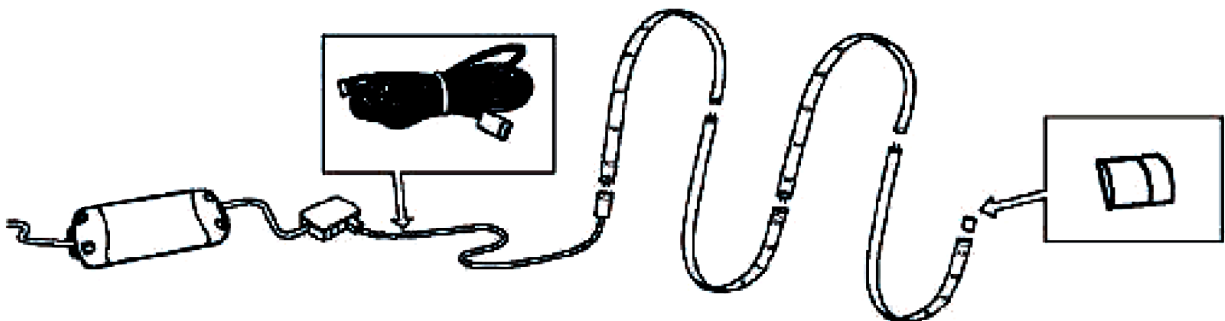

Note: Pricing subject to change without prior notice

12 DIODES LED ACCENT STRIP LIGHTS

- Super bright 12 diodes; surface mounted
- 0.8 Watts, 12 Volts, Bulb Life: 50,000 hours
- Available in Warm White (3200K) or Cool White (5000K)
- Size: 0.31"(8mm) W X 0.24"(6mm) H X 11.81"(300mm) L

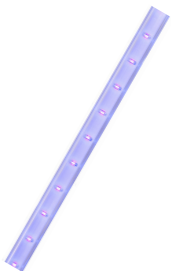

Individual Strips

warm white (3200K)	cool white (5000K)	description
09765639789611	09765637279611	Individual 11.81"L, 12 Diode LED Strip

LED Accent Strip, 4 Strip Light Kits

warm white (3200K)	cool white (5000K)	description
09765639799611	09765637299611	4 Strip Kit w/ 98" cable, 6W Driver w/ 4 Port ML Block
09765639809611	09765637319611	4 Strip Kit w/ 98" cable, 15W Dim. Driver w/ 12 Port ML Block



Compatible Drivers and Dimmable Drivers

item no.	description	Capacity
09765639599611	6 Watts, 12 V, LED Driver with 4 Port ML Block	7
09765639609611	30 Watts, 12 V, LED Driver with 12 Port ML Block	36
09765639759611	15 Watts, 12 V, LED Dimmable Driver with 12 Port ML Block	18

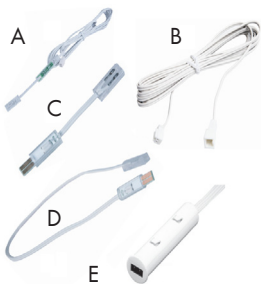

Accessories

item no.	description	application
09765639699611	A 98" Power Cable (Included in Kits)	Connects first LED Flexible Strip to ML Block
09765639539611	B 98" ML Power Extension Cable	Extends distance between ML Block to Light
09765639649611	C 1.18" Linkable Wire	Connects two LED Accent Strips together
09765639639611	D 11.81" Linkable Wire	
09765638169611	E Infrared On/Off Switch	Used to turn lights On/Off

Installation

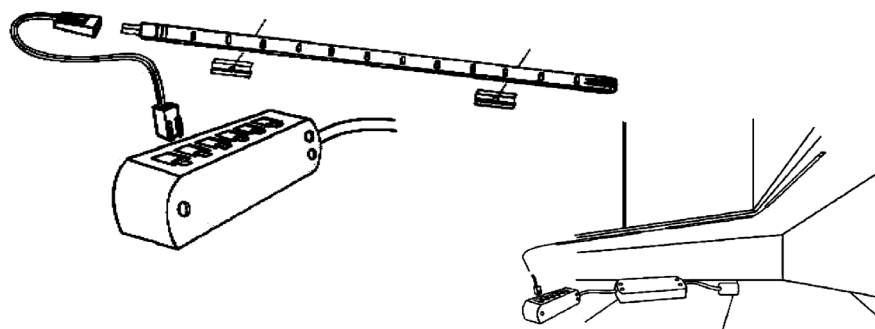

24 DIODES LED ACCENT STRIP LIGHTS

- Super bright 24 diodes; surface mounted
- Can be dimmed off a wall dimmer by using the dimmable driver
- 1.5 Watts, 12 Volts, Bulb Life: 50,000 hours
- Size: 0.31" (8mm) W X 0.24" (6mm) H X 11.22" (285mm) L
- Available in Warm White (3200K) or Cool White (5000K)

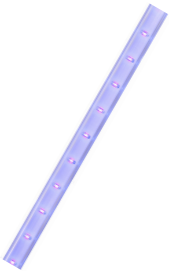

Individual Strips

warm white (3200K)	cool white (5000K)	description
09765639859611	09765637419611	Individual 11.22"L, 24 Diodes LED Strip

LED Accent Strip, 4 Strip Light Kits

warm white (3200K)	cool white (5000K)	description
09765639869611	09765637439611	4 Strip Kit: 98" cable & 6W Driver w/ 4 Port ML Block
09765639879611	09765637459611	4 Strip Kit: 98" cable & 15W Dim. Driver w/ 12 Port ML Block



Compatible Drivers and Dimmable Drivers

item no.	description	Capacity
09765639599611	6 Watts, 12 V, LED Driver with 4 Port ML Block	4
09765639609611	30 Watts, 12 V, LED Driver with 12 Port ML Block	20
09765639759611	15 Watts, 12 V, LED Dimmable Driver with 12 Port ML Block	10

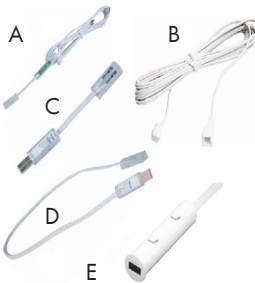

Accessories

item no.		description	application
09765639699611	A	98" Power Cable (Included in Kits)	Connects first LED Flexible Strip to ML Block
09765639539611	B	98" ML Power Extension Cable	Extends distance between ML Block to Light
09765639649611	C	1.18" Linkable Wire	Connects two LED Accent Strips together
09765639639611	D	11.81" Linkable Wire	
09765638169611	E	Infrared On/Off Switch	Used to turn lights On/Off

Installation

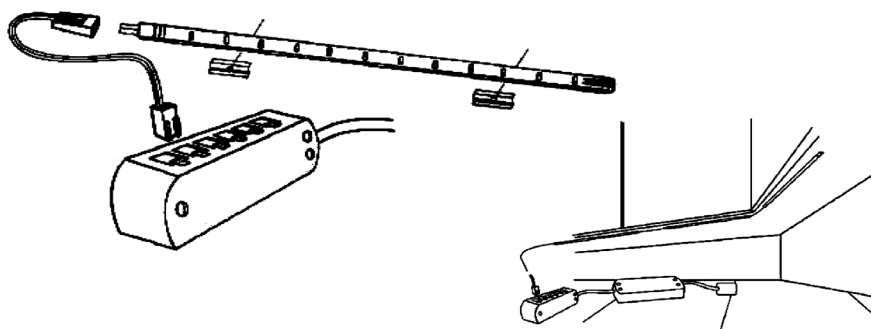

21 DIODES LED ECONOMY PUCK

- Super bright 21 diodes; surface mounted or recess mounted
- Can be dimmed off a wall dimmer by using the dimmable driver
- 59" attached connecting cable
- 1 Watt, 12 Volts, Bulb Life: 40,000 hours
- Recess Mount Size: 2.76" (70mm) Overall Diameter X .71" (18mm) Height X 2.36" (60mm) Bore Hole Diameter
- Surface Mount Size: 2.76" (70mm) Overall Diameter X .94" (24mm) Height
- Available in Warm White (3200K) or Cool White (5000K)



Individual Puck

warm white (3200K)	cool white (5000K)	description
09765637969611	09765637959611	Individual Puck with 59" cable

3 Puck Light Sets

warm white (3200K)	cool white (5000K)	description
09765638029611	09765638019611	3 Puck Kit: 59" cables & 6W Driver w/ 6 Port AMP Block
09765638089611	09765638079611	3 Puck Kit: 59" cables & 15W Dim. Driver w/ 6 Port AMP Block



Compatible Drivers and Dimmable Drivers

item no.	description	Capacity
09765639749611	6 Watts, 12 V, Driver with 6 Port AMP Block	6
09765639779611	15 Watts, 12 V, Dimmable Driver with 6 Port AMP Block	15

Installation

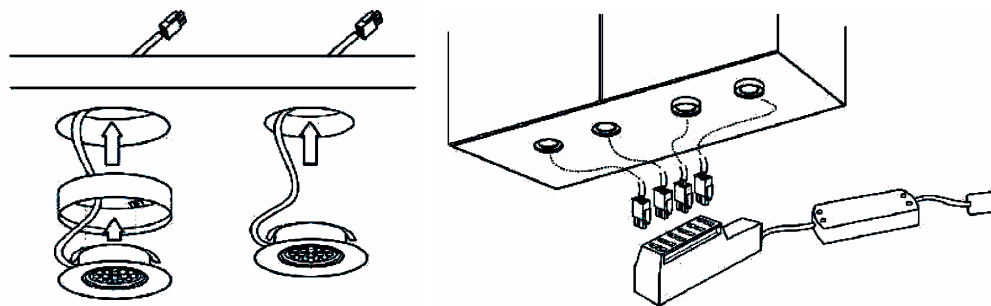

PRO SQUARE HD-LED PUCK LIGHTS

- Bright 18 Diodes; easy surface mount with screws or 3M double sided adhesive pad included
- High Definition (HD) LED lights have a lens over each LED to make the light more intense
- A break through in LED dimming. Can be dimmed off a wall dimmer by using the dimmable driver
- 98" attached connecting cable
- Available in Cool White & Warm White
- Size: 2.625" Square x .375"H
- 1.25 Watts, 24 Volts, Bulb Life: 60,000 hours



Individual Pucks

warm white	cool white	description
PROSA9007HDALWW	PROSA9007HDALWH	1.25W, Square Puck Light w/98" cable, 18 Diodes, 24V



Compatible Drivers and Dimmable Drivers

item no.	description	Capacity
09765639529611	6 Watts, 24 V, LED Driver w/ 4 Port ML Block	4
09765639519611	20 Watts, 24 V, LED Driver w/ 12 Port ML Block	16
09765639509611	30 Watts, 24 V, LED Driver w/ 12 Port ML Block	24
09765639769611	15 Watts, 24 V, LED Dim. Driver w/ 12 Port ML Block	12

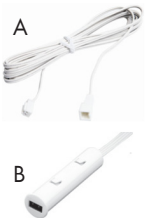

Accessories

item no.		description
09765639539611	A	98" ML Power Extension Cable
09765638169611	B	Infrared On/Off Switch

24 DIODES HD-LED PUCK LIGHTS

- Super bright 24 Diodes; surface mounted or recess mounted
- High Definition (HD) LED lights have a lens over each LED to make the light more intense (50° beam)
- Can be dimmed off a wall dimmer by using the dimmable driver
- 98" attached connecting cable
- 1.65 Watts, 24 Volts, Bulb Life: 60,000 hours
- Recess Mount Size: 2.58" (65.5mm) Overall Diameter X .41" (10.5mm) H X 2.36" (60mm) Bore Hole Diameter
- Surface Mount Size: 2.58" (65.5mm) Overall Diameter X .59" (15mm) H
- Available in Warm White (3200K) or Cool White (5000K)



Individual Pucks

warm white (3200K)	cool white (5000K)	description
09765637029611	09765637019611	Individual HD-LED Puck with 98" cable

3 Puck Light Kits

warm white (3200K)	cool white (5000K)	description
09765637049611	09765637039611	3 Puck Kit: 98" cables & 20W Driver w/12 Port ML Block
09765637069611	09765637059611	3 Puck Kit: 98" cables & 15W Dim. Driver w/12 Port ML Block



Compatible Drivers and Dimmable Drivers

item no.	description	Capacity
09765639529611	6 Watts, 24 V, LED Driver with 4 Port ML Block	3
09765639519611	20 Watts, 24 V, LED Driver with 12 Port ML Block	11
09765639509611	30 Watts, 24 V, LED Driver with 12 Port ML Block	18
09765639769611	15 Watts, 24 V, LED Dimmable Driver with 12 Port ML Block	8

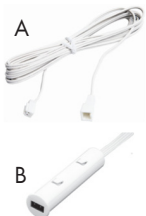

Accessories

item no.		description	application
09765639539611	A	98" ML Power Extension Cable	Extends distance between Driver's ML block to Puck
09765638169611	B	Infrared On/Off Switch	Used to turn lights On/Off

Installation

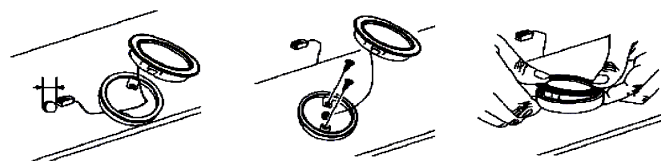

Surface Mounted



Recessed Mounted

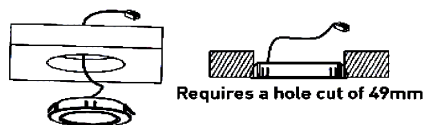

24 DIODES HD-LED SLIDE-ON PUCK LIGHTS

- Super bright 24 diodes; surface mounted on a track
- High Definition (HD) LED lights have a lens over each LED to make the light more intense (50° beam)
- Can be dimmed off a wall dimmer by using the dimmable driver
- Slide the puck to any position on the rail
- 1.65 Watts, 24 Volts, Bulb Life: 60,000 hours
- Slide-On Track Size: 1.5625" W X 35.43" L (track can be cut to size); Puck Size: 2.25" Dia. X .625" H
- Available in Warm White (3200K) or Cool White (5000K)



Individual Pucks

warm white (3200K)	cool white (5000K)	description
09765639549611	09765637119611	Individual HD-LED Slide-On Puck

3 Puck Light Kits (Includes 35.43" Track and Driver)

warm white (3200K)	cool white (5000K)	description
09765637139611	09765639559611	3 Puck Kit: 98" cable, Track & 20W Driver w/ 12 Port ML Block
09765639569611	09765637129611	3 Puck Kit: 98" cable, Track & 15W Dim. Driver w/ 12 Port ML Block

Compatible Drivers and Dimmable Drivers

item no.	description	Capacity
09765639529611	6 Watts, 24 V, LED Driver w/ 4 Port ML Block	3
09765639519611	20 Watts, 24 V, LED Driver w/ 12 Port ML Block	11
09765639509611	30 Watts, 24 V, LED Driver w/ 12 Port ML Block	18
09765639769611	15 Watts, 24 V, LED Dim. Driver w/ 12 Port ML Block	8

Accessories

item no.		description	application
09765639539611	A	98" ML Power Extension Cable	Extends distance between Driver's ML block to Puck
09765638169611	B	Infrared On/Off Switch	Used to turn lights On/Off

Installation

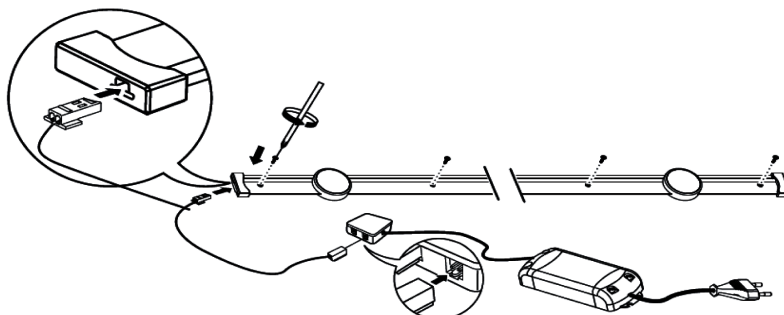

PRO POWER POD

- Aluminum structure with chrome handle
- Independent power switch for outlets and USB
- 3 x power sockets
- 2 x USB sockets (no need to unplug other appliances)
- IP54 (splash proof) rated in unplugged status
- Pull up handle for secure hold
- Size: 90-92mm bore hole x 14"H extension
- Note: Special order only

item no.
PROSA80051AL

PRO
VALUE SERIES



closed position



open position



ATLANTA GA

5075 North Buford Hwy
Suite 100
Peachtree Corners, GA 30071
678.924.0386
888.924.0386
FAX 678.924.0391

CHATTANOOGA TN

234 Direct Connection Drive
Rossville, GA 30741
706.891.2000
800.506.9663
FAX 706.891.4229

RALEIGH NC

4213 Poole Road
Raleigh, NC 27610
919.231.6620
800.982.0999
FAX 919.231.9687

BALTIMORE MD

6660 Santa Barbara Road
Elkridge, MD 21075
410.796.7600
800.935.6229
FAX 410.796.7729

GREENSBORO NC

1819 Baker Road
High Point, NC 27263
336.431.2712
800.662.9060
FAX 336.431.2750

RICHMOND VA

1701 Rhoadmiller Street
Richmond, VA 23220
804.359.1374
800.552.4046
FAX 804.353.3206

CHARLESTON SC

4325 Lear Avenue
N. Charleston, SC 29418
843.529.0808
800.466.8499
FAX 843.529.0805

GREENVILLE SC

1441 Hwy 101 South
Greer, SC 29652
864.877.7328
800.868.9669
FAX 864.877.7413

ROANOKE VA

701 Gainsboro Road
Roanoke, VA 24016
855.300.4455
800.948.7156
FAX 540.344.2306

CHARLOTTE NC

4250 Golf Acres Drive
Charlotte NC 28208
704.394.9479
800.868.0291
FAX 704.398.2162

NORFOLK VA

3307 Chesapeake Blvd.
Norfolk, VA 23513
757.855.3908
800.277.4254
FAX 757.857.6133

TAMPA FL

5102-B W. Hanna Avenue
Tampa, FL 33634
800.432.1149
FAX 813.887.1902